

# MIST FAN

## User and installation manual

### MUNEB -26 -P2



## SAFETY GUIDE

1. Please read the user guide carefully before using the mist fan.
2. Prepare the installation tools follow the user manual before installation.
3. Master the process of using the safety point.

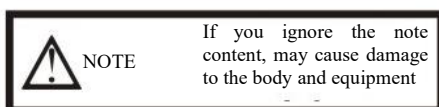
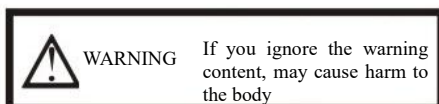

## LOGO INTRODUCTION

	NOTE
	PLUG
	FORBIDDEN
	NO DISASSEMBLY
	NOTE WATERPROOF
	NOTE FIRE

## WARNING

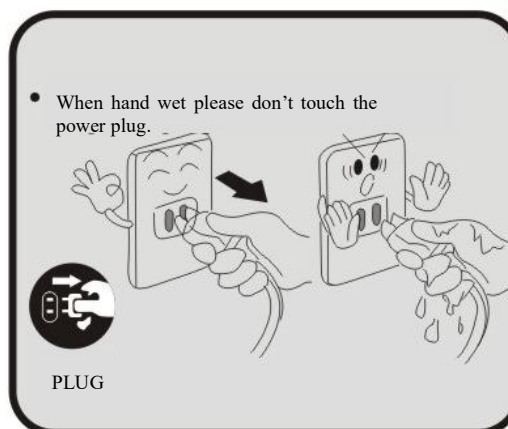
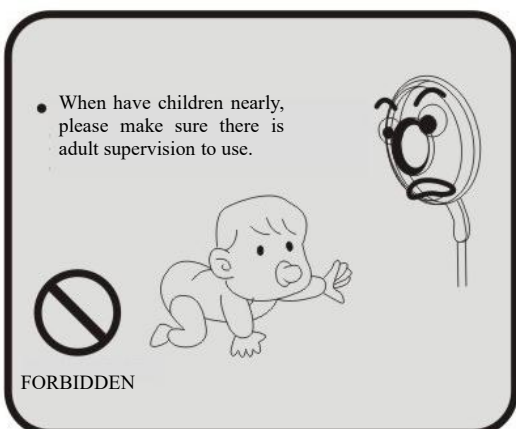
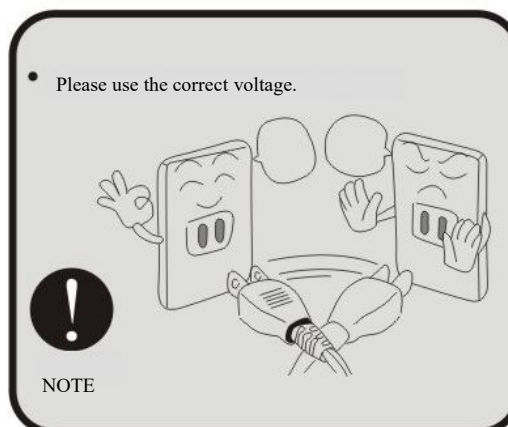
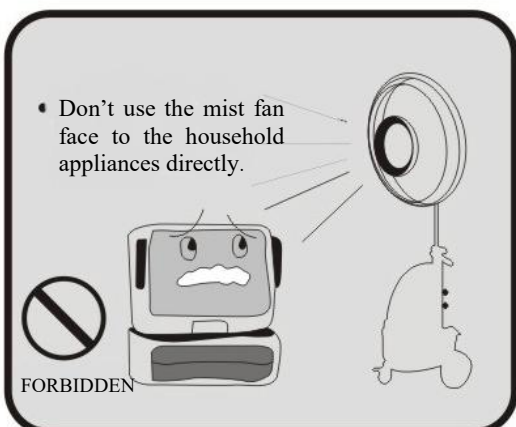

## NOTES

When find a burning smell or smoke plug, please stop to use mist fan.



Plug has burning smell or smoke is an internal connection is bad or the wire aging, continued use will lead into the fire.

NOTE FIRE

Non-professionals may not carry out repairs and modifications mist fan.



NO DISASSEMBLY

While thunder and rain, please stop using mist fan and move it to a safe place..



NO WATERPROOF

Electric parts of mist fan **drop** to water and electrical leakage, causing fires and other serious consequence.

Don't climb, squeeze, and hang heavy objects on fan.

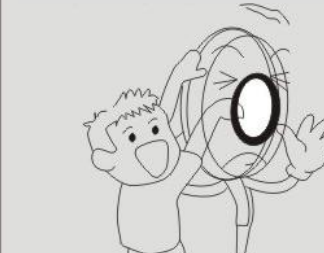

Climbing cause bodily injury, extension and suspension weigh would hurt mist fan.

FORBIDDEN

When the mist fan is working. Please don't touch the fan guard.



UNTOUCHABLE

Fingers easily through the fan guard, when the fan work, easily hurt your fingers.

Please pull plug out from the outlet while mist fan isn't used.

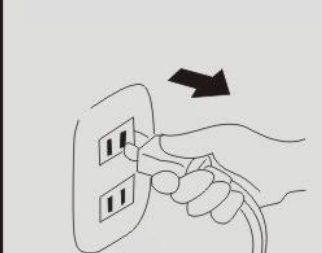

NOTE

Unused for long periods without unplug, easily lead to electrical aging, leakage, fire, etc.

Please pull plug out from the outlet while found electrical smell or smoke from motor.



Abnormal electrical motor internal problems and continue to use will have serious consequences

PLUG

Please check the power outlet, plug, wire are intact before use products.

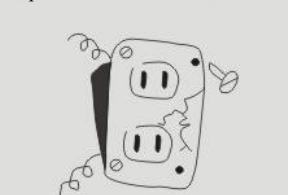

FORBIDDEN

As the poor contact short circuit, often cause serious accidents of fire and electric shock.

Please do not use wire ring together, must be completely untied.



FORBIDDEN

Overheating caused by leakage an important reasons for fire.

Thank you for purchasing water mist fan. Please read this manual carefully before using.

### General Notes:

According to the principle of evaporation heat absorption, mist fan make the surrounding air cool. It is no nozzles jammed problem and required no filtration system or nozzles, no complicate. The mist fans include oscillating fan head, adjustable speeds control, adjustable mist volume control. This system will provide very comfortable water spray to clear the atmosphere: the surrounding air will be comfortable with clean, fresh and cool.

### Application:

1. Cooling: Outdoor restaurants, bus stations, railway stations, waiting areas, hotels, also for work areas, loading docks, zoos, etc.
2. Suppressing dust: Removing atmosphere dust, farming, pollution control, decrease unpleasant odor, etc.
3. Increasing humidity: Used in spinning mills, cotton warehouse, park, greenhouse, testing chambers, flour mills, etc.
4. Agriculture: Used in poultry farms, mushroom plants, birds and animals, improves the operations for all kinds of livestock industries.
5. Special effects of mist: Gardens, zoos, fairs, movies sets, water features, fountain, used for creative fog effects.

## Safety instructions:

1. As instruction manual describe, the installation and operation must comply with local utility standard. Improper use of mist fan may cause fire, electric shock and injury.
2. Don't immerse this system, plug, or cord in water, hail snow or any inclement weather or any other inclement weather. The cord is damaged in any way, don't placed mist fan system.
3. Don't use if the plug or power cord is damaged in any way, don't placed mist fan system near an open flame, cooking or heating appliance, open containers of flammable liquids or gases.
4. Don't hang heavy or sharp objects on the power cord, and don't touch hot surfaces.
5. Don't place any objects through the guards into the blades, also don't operate mist fan without guards in place.
6. The stand type mist fan must be grounded, don't hang or mount it on the wall or ceiling, and the wall type mist fan must be mounted on the wall properly.
7. It is necessary to close supervision when the mist fan is used near children.
8. Disconnect the mist fan from outlet socket when the mist fan isn't in use, when moving the system or before cleaning the system, remove the plug from the electrical receptacle by pulling on the plug and never yank on power cord.
9. Never wash the system with a garden hose, water may harm motor of system, keep all connections dry and off the ground to reduce the risk electric shock, don't touch the plug with wet hands.
10. Must use 3-prong grounded extension cord with mist fan, this plug is intended to fit fully in a grounded outlet only, if the plug dose not fit fully into the outlet, contact a qualified electrician, don't attempt to defeat or disable this safety feature.
11. Make sure the system voltage and frequency are same as local electrical outlet voltage and frequency.

## Care and Storage:

1. Ensure the plug is removed from the electrical outlet before attempting any clearing or maintenance.
2. Clean the water tank regularly.
3. Only use soft moistened cloth to clean the mist fan, don't immerse the mist fan in water.
4. For storage: clean mist fan carefully as instructed and cover with plastic cloth, store the mist fan in clean dry place.
5. Caution: If you find a problem with the fan, please don't open the fan motor housing as this may cause injury, damage to the fan will void your warranty.

## Specification of Mist Fan



Fan diameter: 26 inch 30 inch  
 Fan oscillation adjustable: 90 degrees automatically  
 Fan tilt adjustable: 30 degrees  
 Available area: 30-50m<sup>3</sup>  
 Temperatures drop: 4°C-8°C  
 Operation temperature: 10°C-60°C  
 Operation humidity: 10%-85%  
 Working voltage: 220V-240V  
 Water tank capacity: 49L  
 Continuance water supply: 10 hours

Model	Size (inch)	Power (W)	Voltage (V)	Frequency (Hz)	Height (m)	Motor	Speed	Capacity (L)	Color	Air Flow (m <sup>3</sup> /min)
AY-YD21	26	260	220	50/60	1.75	100%copper	3	49	Blue/black	145
AY-YD22	30	350	220	50/60	1.75	100%copper	3	49	Blue/black	155
AY-YD23	26	300	220	50/60	2	100%copper	3	49	Blue/black	150

- ▲ Place mist fan on the level surface carefully.
- ▲ Make sure the pump inlet is opened.
- ▲ Fill clean water into the tank, minimum level should cover the water pump. Don't operate mist fan without enough water.
- ▲ Adjust misting volume to the appropriate position and plug low speed ensure the fan is operating properly.
- ▲ Start misting switch, ensure all components are operating properly.
- ▲ Adjust misting volume as needed, ensure the return water may return to tank.



## Assembly Instructions of Mist Fan

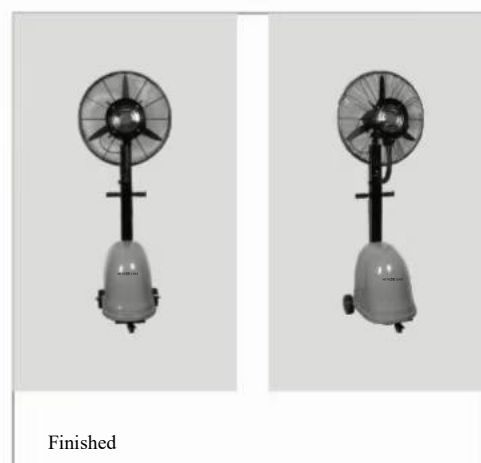
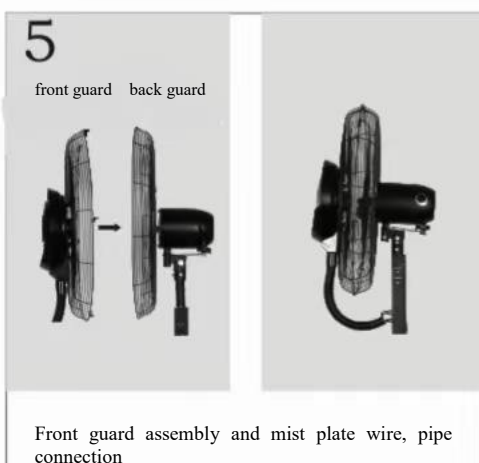
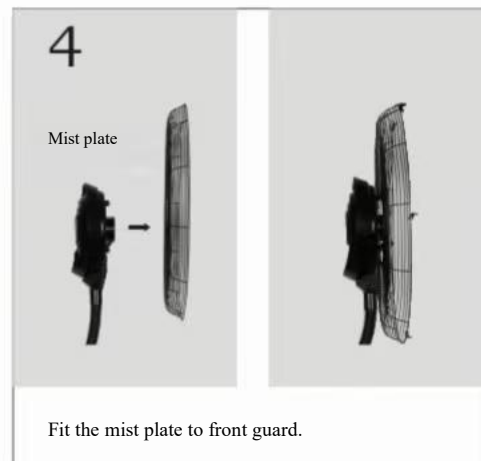
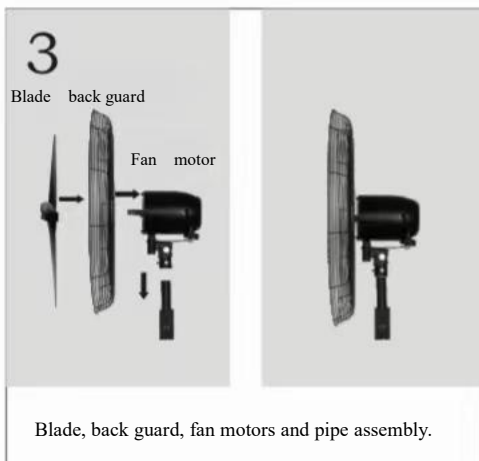
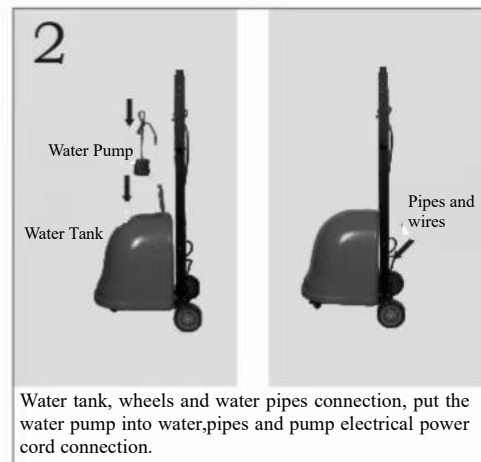
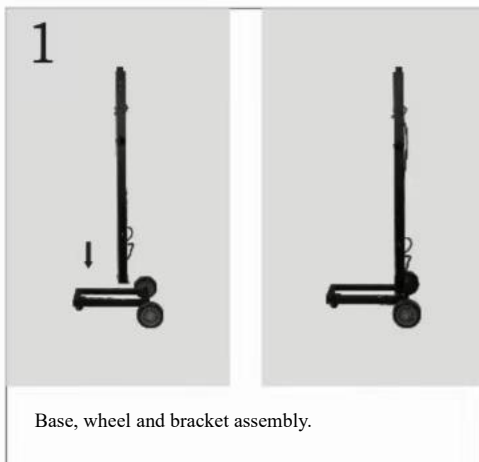

### Warranty terms:

1. This products is guaranteed for one year the warranty applies to repair or replacement while mist fan is found to be defected in material or workmanship. This warranty does not apply to any damage resulting from improper use, artificially damage and transportation. Damage as a result of article factors will not be included in the warranty. You should read the instruction manual before operating it.
2. Warranty clauses are base on the invoice, so when you apply to repair the mist fan, you should take the mist fan with the original invoice of this mist fan together, this warranty only authorized to the original purchaser of this mist fan, any implied warranty of merchantability or fitness for a particular purpose on this mist fan is limited in duration of the duration of the warranty, we aren't liable for incidental or consequential damages of any nature disaster.
3. The final explanation of this belongs to factory.

### Certification

Model No.:\_\_\_\_\_

Production Date:\_\_\_\_\_

Checker:\_\_\_\_\_

Check Date:\_\_\_\_\_

### Customer Information

User Name:\_\_\_\_\_ Agent:\_\_\_\_\_

Date of Buy:\_\_\_\_\_ Invoice No.:\_\_\_\_\_

User Add:\_\_\_\_\_

User Tel:\_\_\_\_\_

(Customer fill)



### Repair Record

Repair Company:	Repair Date:
Repairer:	User Confirm:
Repair Items:	

### Repair Record

Repair Company:	Repair Date:
Repairer:	User Confirm:
Repair Items:	

### Repair Record

Repair Company:	Repair Date:
Repairer:	User Confirm:
Repair Items:	

### Repair Record

Repair Company:	Repair Date:
Repairer:	User Confirm:
Repair Items:	

MUNDO  CLIMA®



[www.mundoclima.com](http://www.mundoclima.com)

C/ ROSSELLÓ , 430-432  
08025 BARCELONA  
ESPAÑA  
(+34) 93 446 27 80  
SAT: (+34) 93 652 53 57