

FAN COIL 2 PIPES FLOOR CEILING MUC-W9/SE Series

MUNDOCLIMA®

MUC-W9/CE Series









FEATURES

- Universal 2 pipes Fan Coil Unit.
- Floor or ceiling installation (vertical / horizontal).
- Bottom air inlet (version CE).
- Installation by hanging or on optional feet (CE version).
- Hydraulic connections on the left side can be switched on site.
- Only 200 mm deep.
- DC fan motor with 7 speeds.
- Input 0-10V.
- Accurate temperature control (0.5°C).
- The compensation temperature can be modified.
- Remote ON / OFF signal and alarm.
- Allows connection to centralized CCM control.
- Integrated Modbus communication (RTU).
- Does not include controller, KJRP-75A/BK-E (LC04630) is recommended , can be installed inside the enclosure (CE version) or on the surface.

OPTIONAL COMPONENTS

More information on the optional components in "MUNDOCLIMA CONTROL SYSTEMS"

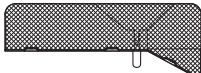
RECOMMENDED		<i>Wired remote control</i>		<i>Centralized controller</i>			<i>BMS</i>
	KJRP-75A/BK-E (LC 04 630)		TFDS2T (CO 14 210)	CCM30/BKE (CL 92 871)	CCM15 (CL 92 872)		MD-AC-KNX (CL 94 792 / CL 99 094-095)

<i>Accessories</i>					
					
KJR-150A/M-E (CL 97 156)	Actuator Valve (CO 12 231)	3 way valves with bypass (CO 12 151)	Set of valve connection tubes (Mods. 05/08/11/16/19: LC 04 632) (Mod. 24: LC 04 633)	Condensate tray valve* (Mods. 05/08/11/16/19: LC 04 634) (Mod. 24: LC 04 635)	2 stands set (LC 04 631)

*2 units are included with each code, only one tray per appliance is needed.

W9 Series FAN COIL 2 PIPES FLOOR CEILING

TECHNICAL SPECIFICATIONS

Model	Without casing (Version SE)		MUC-05-W9/SE	MUC-08-W9/SE	MUC-11-W9/SE	MUC-16-W9/SE	MUC-19-W9/SE	MUC-24-W9/SE		
	With casing (Version CE)		MUC-05-W9/CE	MUC-08-W9/CE	MUC-11-W9/CE	MUC-16-W9/CE	MUC-19-W9/CE	MUC-24-W9/CE		
Code	Without casing (Version SE)		CL 04 630	CL 04 631	CL 04 632	CL 04 633	CL 04 634	CL 04 635		
	With casing (Version CE)		CL 04 640	CL 04 641	CL 04 642	CL 04 643	CL 04 644	CL 04 645		
Cooling	Capacity (High / Medium / Low) (*1)		kW	1.50/1.06/0.92	2.35/1.94/1.19	3.5/2.89/2.22	4.3/3.48/2.71	5.6/4.47/3.14	7.35/6.12/4.57	
	Water flow (High / Medium / Low)		m³/h	0.27/0.2/0.17	0.41/0.35/0.23	0.61/0.51/0.4	0.54/0.36/0.22	1.01/0.8/0.56	1.28/1.10/0.81	
	Loss of charge (High / Medium / Low)		kPa	13.9/8.21/6.16	13.3/9.98/4.59	34.1/24.63/15.39	54.2/36.22/22.78	50.7/33.38/17.73	44.1/33.7/19.41	
Heating	45°C (2)	Capacity (High / Medium / Low) (*2)		kW	1.57/1.07/0.92	2.60/2.11/1.34	3.5 / 2.87 / 2.19	4.3 / 3.43 / 2.6	6.0 / 4.77 / 3.36	8.05/6.46/4.71
		Water flow (High / Medium / Low)		m³/h	0.31/0.21/0.18	0.47/0.39/0.24	0.68/0.56/0.43	0.85/0.81/0.68	1.14/0.92/0.64	1.40/1.14/0.84
		Charge drop (High / Medium / Low)		kPa	15.1 / 7.63 / 5.84	14.3 / 10.33 / 4.5	35.1 / 24.41 / 14.82	54.3 / 36.87 / 22.32	55.5 / 37.66 / 19.27	46.9 / 31.9 / 18.16
	50°C (3)	Capacity (High) (*3)		kW	2.17	3.45	4.89	6.02	7.76	10.69
		(Water flow) (High)		m³/h	0.37	0.59	0.84	1.04	0.84	1.84
		Water pressure drop (High)		kPa	19.39	19.09	4.14	65.75	23.90	61.11
Air flow rate (High / Medium / Low)			m³/h	255/170/150	400/315/190	595/470/340	790/580/410	1190/855/505	1360/1015/685	
Static pressure			Pa	0	0	0	0	0	0	
Exchanger water volume			L	0.450	0.681	0.902	0.902	1.023	1.534	
Power supply			V/Ph/Hz	220-240/1/50	220-240/1/50	220-240/1/50	220-240/1/50	220-240/1/50	220-240/1/50	
Consumption (High/Medium/Low)			W	15 / 9 / 8	17 / 12 / 7	26 / 17 / 10	50 / 25 / 14	96 / 44 / 17	113 / 53 / 22	
Sound pressure (High / Medium / Low) (*4)			dB(A)	34 / 24 / 21	29 / 24 / 20	38 / 32 / 25	46 / 38 / 30	51 / 43 / 31	52 / 44 / 33	
Sound power (High / Medium / Low) (*4)			dB(A)	47 / 37 / 34	43 / 37 / 29	52 / 45 / 37	59 / 52 / 43	65 / 58 / 56	64 / 58 / 49	
Max. working pressure			MPa	1.6	1.6	1.6	1.6	1.6	1.6	
Water inlet temperature range (min ~ max)			°C	3 - 75	3 - 75	3 - 75	3 - 75	3 - 75	3 - 75	
Water connections			inch	3/4"	3/4"	3/4"	3/4"	3/4"	3/4"	
Drainage connection (external diameter)			mm	Ø18.5	Ø18.5	Ø18.5	Ø18.5	Ø18.5	Ø18.5	
Dimensions	SE version (Length x Height x Depth) (5*)		mm	628x455x200	858x455x200	1078x455x200	1078x455x200	1198x455x200	1198x551x200	
	CE version (Length x Height x Depth)		mm	790x495x200	1020x495x200	1240x495x200	1240x495x200	1360x495x200	1360x591x200	
Weight	Version SE		kg	11.8	13.9	17.3	17.3	19.6	23.1	
	Version CE		kg	18	21.5	25.5	25.5	28.5	32.5	

Notes:

- (1) Cooling capacity for each of the three air flow rates according to the conditions: Water inlet/outlet temp. 7/12 °C Outdoor temp. 27°C DB, 19°C WB.
- (2) Heating capacity for each of the three air flow rates according to the conditions: Water inlet/outlet temp. 45/40 °C Outdoor temp. 20°C.
- (3) Heating capacity at high speed and according to conditions: Water inlet/outlet temp. 50°C/ 45°C Environment 20°C (for other temperatures consult the technical manual).
- (4) Sound pressure level measured in a reverberation chamber, at a distance of 1 m from the equipment, both horizontally and vertically
- (5) The length does not include the dimensions of the electrical box (+71 mm), or the optional valve tray (+71+37 mm).

- The above design and specifications are subject to change of product improvement without prior notice.

DIMENSIONS

MUC-W9/CE Series

MUC-W9/SE Series

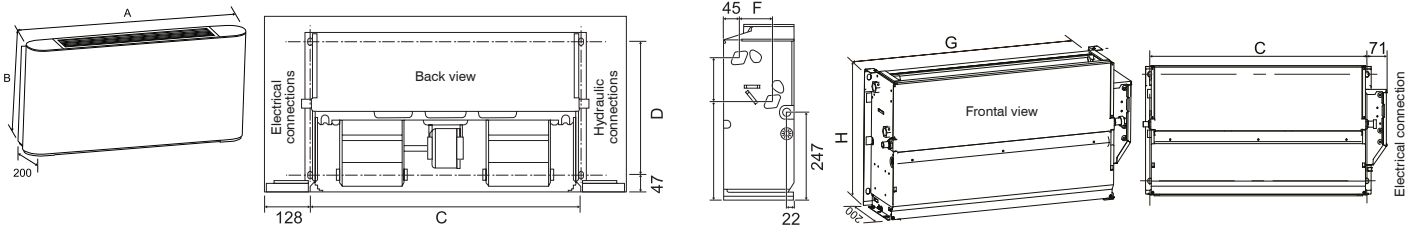

Model	MUC-05-W9	MUC-08-W9	MUC-11-W9	MUC-16-W9	MUC-19-W9	MUC-24-W9
A (mm)	790	1020	1240	1240	1360	1360
B (mm)	495	495	495	495	495	591
C (mm)	534	764	984	984	1104	1104
D (mm)	375	375	375	375	375	391
E (mm)	123	123	123	123	123	219
F (mm)	93	93	93	93	93	102
G (mm)	628	858	1078	1078	1198	1198
H (mm)	455	455	455	455	455	551