

PORTABLE AIR CONDITIONERS MONOBLOC UNIT

MUPO-C10 / H10 Series

with outlet pipe to the outside
and remote control



Ventilation function

It allows operation only with ventilation.



Remote control

Includes wireless remote control.



Air discharge tube to the outside

Easy and quick to install, it allows the use of the air conditioner immediately.



Dehumidification

Moisture reduction restoring an optimum temperature in wet areas.



Condensate removal

Removes condensate water so it is not necessary to connect the air conditioner to a drain. In dehumidification mode and in very humid environments, it is recommended to connect the equipment to a drain.

NEW!



MUPO-07-C10



MUPO-09-H10



Window kit included

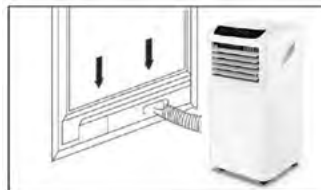

TECHNICAL SPECIFICATIONS

MODEL			MUPO-07-C10	MUPO-09-H10
Code			CL 20 020	CL 20 021
Cooling	Nominal capacity	kW	2.05	2.63
	Nominal consumption PEER	kW	0.78	1.03
	EERd	W/W	2.63	2.63
	Energy labeling		A	A
	Electricity Consumption QSD	kWh/60min.	0.778	1.002
Heating	Nominal capacity	kW	--	2.05
	Nominal consumption PCOP	kW	--	0.83
	COPd	W/W	--	2.46
	Energy labeling		--	A
	Electricity Consumption QSD	kWh/60min.	--	0.832
Power consumption in thermostat-off mode PTO		W	--	--
Standby power consumption PSB		W	0.5	0.5
LWA sound power level		dB(A)	65	65
Power supply		V-Hz-Ph	220-240V~ 50Hz, 1N	
Max. intensity		A	3.5	4.5
Air flow rate	Indoor (High / Low)	m³/h	300 / 280	340 / 320
	Exterior	m³/h	300	340
Refrigerant	Type / PCA		R290 / 3	
	Number	kg / TCO ₂ eq	0.12 / 0.0	0.18 / 0.0
Dimensions (W x D x H)		mm	300 x 300 x 700	350 x 348 x 701
Weight		kg	20	24

Warning: 1. Data and specifications are subject to changes without previous notice.
2. The values of sound power level match with values obtained in the anechoic chamber.