

## PORTABLE AIR CONDITIONERS MONOBLOC UNIT

MUNDOCLIMA®

### MUPO Series C9/H9 with outlet pipe to the outside and remote control

**Gas R290**  
More Ecological



**Ventilation function**  
It allows operation with only ventilation.



**Remote control**  
Includes wireless remote control.



**Air discharge tube to the outside**  
Easy and quick to install, it allows the use of the air conditioner immediately.



**Dehumidification**  
Moisture reduction restoring an optimum temperature in wet areas.



**Condensate removal**  
Removes condensate water so it is not necessary to connect the air conditioner to a drain. In dehumidification mode and in very humid environments, it is recommended to connect the equipment to a drain.



**Follow Me Function (iFEEL)**  
The wireless remote control adds a temperature sensor (only in MUPO-12-H9 Series).

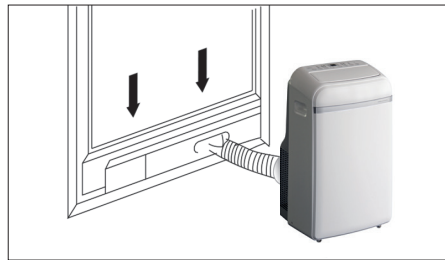

Window kit included

### TECHNICAL SPECIFICATIONS

Model			MUPO-07-C9	MUPO-09-H9	MUPO-12-H9
Code			CL20013	CL20019	CL20014
Cooling	Nominal capacity	kW	2.06	2.64	3.5
	Nominal consumption P <sub>EER</sub>	kW	0.792	1.01	1.35
	EER <sub>d</sub>	W/W	2.6	2.6	2.6
	Energy labeling		A	A	A
	Electricity Consumption Q <sub>sd</sub>	kWh/60min.	0.792	1.01	1.4
Heating	Nominal capacity	kW	-	2.1	2.9
	Nominal consumption P <sub>COP</sub>	kW	-	0.905	1.04
	COP <sub>d</sub>	W/W	-	2.3	2.8
	Energy labeling		-	A	A+
	Electricity Consumption Q <sub>sd</sub>	kWh/60min.	-	0.905	1.1
Power consumption in thermostat-off mode Pro		W	-	-	1
Standby power consumption P <sub>ss</sub>		W	1	1	0.5
Sound power level L <sub>wa</sub>		dB(A)	65	65	65
Power supply		V-Hz-Ph	220-240V~ 50Hz, 1N		
Max. current		A	3.51	4.4	8
Air flow rate	Indoor	m³/h	300	350	420/370/355
	Exterior	m³/h	300	350	535
Diameter of air discharge hose		mm	150	150	150
Refrigerant	Type / PCA		R290/3		
	Amount	kg / TCO <sub>2</sub> EP	0.13/0.0	0.21/0.0	0.230/0.0
Dimensions (W x D x H)		mm	305x328x678	354x338x698	467x397x765
Weight		kg	21	22	34.4

Warning: 1. Data and specifications are subject to changes without previous notice.  
2. The values of noise level match with values obtained in the anechoic chamber.